



## Screw Joint Alloy 6063 Aluminum Solar Panel Frame , Steel Polished Extruded Aluminum Profile

Our Product Introduction

for more products please visit us on [aluminumextrusion-profiles.com](http://aluminumextrusion-profiles.com)

### Basic Information

- Place of Origin: China
- Brand Name: HT
- Certification: CA ,CE
- Minimum Order Quantity: 1 ton
- Packaging Details: Packed with EP ,Carton ,Pallet or wooden case
- Delivery Time: 20days
- Payment Terms: T/T ,L/C
- Supply Ability: 3000tons each month

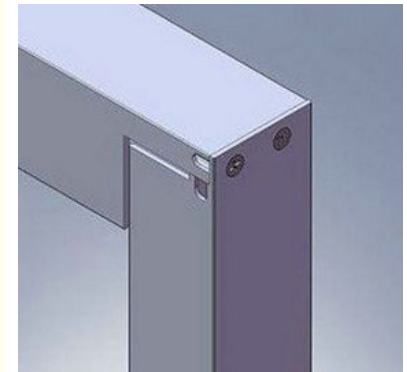

### Product Specification

- Product Name: Aluminum Solar Panel Frame
- Alloy: 6063,6061,6005
- Material: Aluminum
- Surface Treatment: Mill Finished,Anodized ,Electrophoretic Coated,Powder Spray Coated
- Deep Process: Milling, Drilling, Bending,Cutting
- Temper: T4, T5, T6 ,T66
- Highlight: **aluminium solar panel frame, anodized aluminum frame**



## Product Description

### Screw Joint Alloy 6063 Aluminum Solar Panel Frame , Steel Polished Extruded Aluminum Profile

- 1.Alloy :6063,6061,6005 or according to customer' s choice
- 2.Material:Aluminum
- 3.Surface Treatment: Mill Finished,Anodized ,Electrophoretic coated,Powder spray coated,Fluorocarbon powder spray coated /PVDF Paint, Drawbench,Steel polished,Wood grain coated /Wooden transfer .
- 4.Deep process: Milling, Drilling, Bending,Cutting.
- 5.Application: Aluminum solar frame is widely used as the frame of solar panel.
- 6.Color:clear, satin, bronze, black, golden, silver, other multicolor
- 7.Temper: T4, T5, T6 ,T66

#### Description:

##### Aluminum Extrusion Solar Panel Frame

Aluminum solar frame is widely used as the frame of solar panel, and then it is also called as aluminum solar panel frame. Our aluminum solar frames adopt L connector or screw joint, resulting in well fixed structure with durability. They are of high quality and at low price.

#### Features:

- 1) 30\*25 suitable for 30-120W solar modules
- 2) 35\*35 suitable for 80-180W solar modules
- 3) 50\*35 suitable for 160-220W solar modules
- 4) Many other custom made sizes available, such as: 45\*35mm, 60\*35mm, 46\*40mm, 46\*50mm, etc.

#### Specifications :

Item	Aluminum Extrusion Solar Panel Frame
Material	Alloy 6063, 6061 or according to customer' s choice
Temper	T3, T4, T5, T6
Surface	Anodize (clear, satin, bronze, black, golden, silver, other multicolor) , electrophoresis, powder coating, PVDF coating, wood grain painting, etc.
Color	Any color based on Standard Germany RAL Mark
MOQ	1 ton. Usually 12 tons for a 20 feet container; 24 tons for a 40 feet container.
Profile type	used as the frame of solar panel
Fabrication	1. Milling; 2. Drilling; 3. Bending; 4. Cutting.
Moulding	1. Using our moulds, free; 2. Using customer' s drawing, opening mould fee need to be paid.
Mould size	25*25, 35*35,30*46, 46*50, 30*25, 40*40 ,50*35,etc.We can provide customized aluminum solar frames upon to customers' request.
FOB Port	Shanghai, etc.

新图号 旧图号	简 图	线密度 kg/m	新图号 旧图号	简 图	线密度 kg/m
GT001 G701		0.987	GT007 G007		0.803
GT002 角码为GT001 G702		0.530	GT008 G008		0.633
GT003 G795		0.615	GT009 G009		0.494
GT004 G794		0.466	GT010 G010		0.496
GT005 G590		0.814	GT011 G011		0.388
GT006 G591		0.681	GT012 G012		0.290

新图号 旧图号	简 图	线密度 kg/m	新图号 旧图号	简 图	线密度 kg/m
GT013 G778		0.372	GT019 G599		0.665
GT014 G594		0.367	GT020 G846		0.400
GT015 G595		0.183	GT021 Z081		0.884
GT016 G596		0.248	GT022 Z082		1.228
GT017 G597		0.534	GT023 Z083		0.952
GT018 G598		0.339	GT024 Z084		1.073

线密度仅供参考，出货以实际称重为准！      **210**

新图号 旧图号	简 图	线密度 kg/m	新图号 旧图号	简 图	线密度 kg/m
GT025 角码为GT026		0.653	GT031		0.548
G895			G893		
GT026		0.732	GT032		0.279
G896			G894		
GT027 角码为GT026		0.424	GT033		1.711
G915			G913		
GT028 角码为GT026		0.524	GT034 角码为GT033		0.745
G916			G914		
GT029		1.300	GT035		0.398
G822			G222		
GT030 角码为GT029		0.567	GT036		0.754
G823			G224		

新图号 旧图号	简 图	线密度 kg/m	新图号 旧图号	简 图	线密度 kg/m
GT037 G229		0.172	GT052		0.728
GT038 G230		0.374	GT054 角码为GT052		0.509
GT039 G889		0.626	GT055 角码为GT052		0.537
GT040 G888		0.756	GT061		0.161
GT041 角码为GT026 G187		0.692	GT062		0.340
GT042 角码为GT026 G789		0.443	GT063		0.209

新图号	简图	线密度 kg/m
旧图号		
GT064		0.394
GT068		0.497
GT069		0.613
GT070		0.312
角码为 GT050		
GT071		0.687
GT072		0.378

新图号	简图	线密度 kg/m
旧图号		
GT076		0.698
角码为 GT050		
GT077A		0.848
GT078A		0.635
GT079		0.524
GT080		0.651
GT081		0.395

**213** 线密度仅供参考, 出货以实际磅重为准!

HD太阳能系列型材图      国家免检

新图号	简图	线密度 kg/m
旧图号		
GT082		0.245
GT083		0.267
GT084		0.519
GT085		0.646
GT086		0.674
GT087		0.655
GT088		0.677
GT089		0.558
GT091		0.580
GT092		0.967
GT093		0.832
GT094		1.519

线密度仅供参考，出货以实际磅重为准！ 214

**Applications:****Competitive Advantage:**

In addition to high quality ,we at Hentec office offer customer complete service .Our aluminum solar frame comes with a 15 year warranty .Maintenance service is also available .

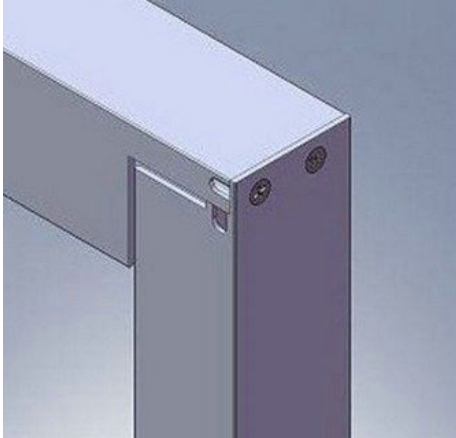

**HENTEC** Hentec Industry Co.,Ltd

+86-13861643436

aluminum@hentec.com.cn

aluminumextrusion-profiles.com

Qinfeng Road No.555 Huashi Town Jiangyin Jiangsu China (mainland) 214421